

microBIOMETER® Classic Soil and Compost Testing Procedure

microBIOMETER® App

1

Create an account on the app and log in. Choose the PRO version. Click the Start the Test button. Choose which medium you are measuring (soil, container soil, or compost). Click the Start the test from the beginning button.



SIFT SOIL

2

Sift soil into the plastic bag provided or in a container of your choice. Pick out any large organic matter such as rocks or twigs.



ADD WATER

3

Fill the capped measuring tube to the top with water and add it to an extraction tube.



ADD EXTRACTION POWDER

4

Tear open the extraction powder packet and empty the contents into the extraction tube. Whisk for a few seconds, mixing the powder into the solution.



MEASURE SOIL

5

Fill sampler syringe with sieved soil to 1ml mark. Press your finger against the tip of the syringe and compact the soil to the 0.5ml mark, removing any excess from the tip of the syringe. Add the measured soil into the extraction tube.



6

MIX SOLUTION

If your soil is very compacted due to a high clay content, use the metal spatula to break up before whisking. Let the whisker rest in the mouth of the tube. No hands are needed. Mix the solution for 30 seconds using the timer provided. The rotating motion of the whisker aids in the extraction process.



7

SETTLE SOLUTION

Let the extraction tube settle for 5 minutes. After the time has elapsed, tap the bottom of the tube 3-4 times on a hard surface to settle floating debris. Let the extraction tube settle for an additional 15 minutes. Use the timer provided.



8

SAMPLE SOLUTION

Use a small pipette to draw up solution from about 1 inch below the surface, avoiding any debris.

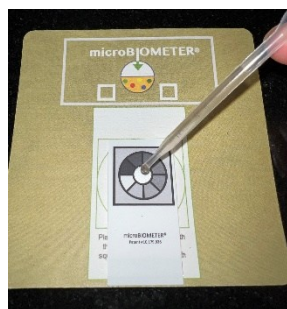

9

PLACE DROPS ON TEST CARD

Center the test card on the white region of the supplied background. Apply 3 drops of the solution onto the sample window. Allow each drop to completely absorb before adding the next drop. Avoid wetting the printed grayscale surrounding sample window.

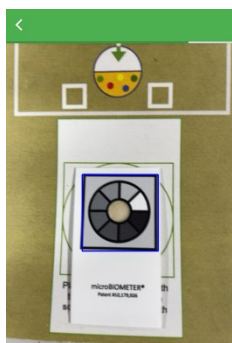

10

ANALYZE WITH THE APP

Scan the test card exactly 2 minutes after applying drops. Align the blue square on the screen with the black square on the sample card. The blue square is a guide – it will turn green when the app has successfully read the card.